



**The Combined Benefices of  
Pocklington Wold  
and  
Londesborough Wold**

## Introduction

Thank you for your interest in our Pocklington Group of Churches. Our group consists of All Saints Church Pocklington (the largest community), and eight smaller village churches serving their rural villages and surrounding countryside. We are fairly traditional in appearance, but we are seeking new ways to serve our communities.

We hope you will find this profile both informative and inspiring. We have tried to be as open as possible regarding our group of churches, highlighting the challenges and opportunities you and we together, will meet.

It is our group's hope and prayer that the next chapter of the life of our churches will be one of renewal. We would love to see many more in our community find and deepen their love of God and to see our communities enriched and blessed by our work. This is an important, but exciting time for us all. We hope you will consider us as a home for your ministry.

## Contents

1.	<a href="#">Message from the Archdeacon of York</a>	Page 3
2.	<a href="#">Message from the Deanery of South Wold</a>	Page 4
3.	<a href="#">Our Future Vision, Our Strengths and Opportunities</a>	Page 5
4.	<a href="#">What we are looking for in our new vicar</a>	Page 6
5.	<a href="#">Schools in our benefice</a>	Page 7
6.	<a href="#">Profiles of our parishes</a>	Page 8
	• <a href="#">All Saints, Pocklington</a>	Page 9
	• <a href="#">St. Giles, Burnby</a>	Page 13
	• <a href="#">St. Ethelburga, Great Givendale</a>	Page 16
	• <a href="#">St. Martin, Hayton</a>	Page 18
	• <a href="#">St. Mary, Huggate</a>	Page 20
	• <a href="#">All Saints, Londesborough</a>	Page 22
	• <a href="#">St Margaret, Millington</a>	Page 24
	• <a href="#">St. James, Nunburnholme</a>	Page 26
	• <a href="#">All Saints, Shiptonthorpe</a>	Page 29
7.	<a href="#">Our Resources</a>	Page 31
8.	<a href="#">Sample rota of services</a>	Page 32
9.	<a href="#">The Vicarage</a>	Page 33
10.	<a href="#">Our Local Area</a>	Page 35

## Message from the Archdeacon of York



Are you ready to answer the call to ministry in the lovely market town of Pocklington and the surrounding rural village churches of this benefice?

These churches and communities are looking for an imaginative, missional leader who will work with them:

**‘To see our Christian communities grow in faith and discipleship, reflecting God’s love as we seek to reach out to those around us.’**

This post offers many opportunities for imaginative mission and shared ministry with distinctive challenges and possibilities for future development. If you apply and are appointed we will support you as you explore these and join with us in God’s mission to this Diocese.

Our Diocesan vision is that by God’s grace we will become generous churches, making and nurturing disciples who are growing in Christlikeness, commitment, partnership, influence and numbers.

In particular we are focussing our energies on reaching those we don’t yet reach, particularly the 20s-40s and people in poverty, on numerical growth and on establishing sustainable finances.

A major challenge of this role will be to contextualise these goals within this group of churches and this will require prayerful, compassionate and collaborative ministry which enables each place to share in the journey together.

What makes this an exciting role are the parishes themselves and their desire to grow in this way. Their vision, focused around **outreach, growth, renewal and empowerment** set the context for an adventure in faith.

This post also represents an opportunity to help our Diocese improvise effectively in market town mission and ministry within a creative and supportive deanery. The details of the appointment are in the Profile below.

May the Spirit guide you as prayerfully you consider whether to apply for this role.

*The Venerable Sarah Bullock*

## Message from South Wold Deanery



The Pocklington group is the largest benefice in South Wold deanery – a deanery which stretches eastwards from near the outskirts of York and includes much of the Wolds countryside, through which run the 70-mile Wolds Way and other walking routes.

Predominantly a rural deanery, its main centres of population, after Pocklington, are the market town of Market Weighton and the large villages of Stamford Bridge and Holme-upon-Spalding-Moor which lie at opposite ends of the deanery. The five benefices all served by a full-time priest and the two which have a part-time priest include 31 parishes in total, most of which are small, rural villages.

Owing to its size and central location, Pocklington has always played a key role in the life of South Wold deanery. The large parish church offers a natural venue for deanery as well as benefice gatherings and a wide range of musical events. Two years ago, for example, the church hosted a significant deanery

celebration to mark the completion of the Archbishop of York's Prayer Walk. On occasions, members of the Pocklington ministry team have given help in neighbouring parishes struggling to find Eucharistic cover.

Though small in numbers of stipendiary clergy, the deanery offers a warm and welcoming clergy chapter as well as a deanery synod which is currently developing cross-parish links and pioneering deanery events. This follows on from the diocesan strategy of making the deanery a vital network of local churches supporting and resourcing mission. We also have a small reading group for serving and retired clergy. Across the deanery there are ten self-supporting or retired priests who play an important part in the ongoing ministry.

Within the deanery there are good ecumenical links as well as the opportunity to take advantage of worship events at York Minster and training courses at the Diocesan Offices. Also within easy distance there is Beverley Minster, which has an attractive programme of worship and musical events. South Wold deanery would be glad to welcome a priest who felt called to the exciting opportunities of developing the mission and ministry of the Pocklington group.

(Canon) Rodney Nicholson

Interim Area Dean

## Our Vision

To see our Christian communities grow in faith and discipleship, reflecting God's love as we seek to reach out to those around us.

## Our Strengths

- **Friendly & Welcoming** – Friendly and welcoming churches at the heart of our communities.
- **Worshipful** – Worshipful communities including prayer and bible study groups.
- **Strong Ministry and Pastoral Support** – Dedicated support teams across the group, providing ministry, pastoral, and administration support.
- **Strong Organisational Support** – A faithful, dedicated group of people who ensure good organisational structures to maintain our church buildings, organise events and administration.
- **Dedicated Volunteers** – A hard working group of volunteers who run a range of social events and fundraising activities.
- **Good Links with the Local Community** – Including local schools and local charities who use our church buildings.
- **Ecumenical Partners** – Working with other denominations as “Churches Together” in Pocklington.

## Our Opportunities

- **Group Reform** – To achieve more integration and work strategically as a group, while respecting the importance of the individuality of our different parishes.
- **Reaching out** – To those who don't presently engage with church
- **Growth** – To seek to grow our churches, both in numbers of attendees and spiritual growth
- **Renewal** – To seek to adapt our buildings to create flexible, useable spaces for activities
- **Empowerment** – To seek to empower each church within the group, to maximise the talents and skills of individuals in order to serve each other and the community
- **Finances** – To seek to develop a stable and sustainable financial basis across the group

## **What we are looking for in our new vicar**

### **Someone who has:**

- A calling for a rural type of ministry with a large town church at the centre
- Vision, to help us realise and develop our vision for the future
- Energy, to build fellowship, encourage spiritual growth and deepen discipleship
- Leadership, which develops leadership in others
- Encouragement, for us to change and capitalise on our future potential
- Enthusiasm, to help us find ways to be at the heart of the wider community, especially amongst families and younger people
- Involvement, to take an active part in the wider community
- Willingness, to be seen out and about across our group
- Good communication skills, an ear to listen and a heart to love
- A sense of humour!

### **What we can offer you:**

- Support – dedicated support of a large ministry team and pastoral care team, all assisted by two paid part time administrators.
- Enthusiasm – enthusiastic hard working people seeking to grow an active Christian presence at the heart of our communities.
- Members of our group attended LYCIG in September 2016, we would love to develop this further.
- Openness – to change, new ideas and ways of working.
- Friendliness – a friendly, appreciative and supportive environment.
- Community – good links with local schools and groups including two local Church of England schools.
- Management – good supporting financial management structures.

### **Some of our school children said a Vicar should:**

- be child and adult friendly
- be compassionate
- be kind and caring
- have a loud voice
- be confident
- show generosity
- listen and put others first
- be a Christian!



## The Schools in our Group



**Pocklington CE Infant School** is a happy school where children love learning. Along with our focus on academics, we recognise the importance of pupils' social and emotional development. We have staff trained to support the development of good mental health and self-esteem. We work in close partnership with our pupils, their parents and carers and our local community, particularly All Saints Church in Pocklington. We are proud to be a Church School and our Christian Values are central to everything we do.

Lynn Bartram – Headteacher. <http://www.pocklington-infants.org.uk/>



**Warter C. E. Primary School** - The aim of our school is to enable every child to grow intellectually, morally, spiritually and physically in a caring Christian community. We seek to help children achieve their full potential by encouraging a love of learning and the development of self-esteem and confidence. As a Church school we aim to develop Christian values and foster a respect for other people and their beliefs, as positive participants in the world community.

Alison Metcalfe – Headteacher. <http://www.warterschool.eriding.net/>



**Pocklington Community Junior School** - We have unashamedly high expectations of behaviour and attitude towards learning; no-one can be the best at everything, but we expect everyone to try their best on a daily basis and aim high in everything they do. Our provision is geared toward developing individual talents and celebrating success in all aspects of school life.

Alex Reppold – Headteacher. <http://www.pocklingtonjuniors.co.uk/>



**Woldgate School** - Our view of an outstanding school is based on shared values, where every child is known and cared for as an individual. To cultivate this, we build a supportive and caring community, where a child's talents can grow through academic study and the opportunity to participate in the many activities, productions and visits that make Woldgate School unique. We are a school with a positive, welcoming, warm atmosphere, in which pupils take pride in their achievements and where each individual pupil achieves academically through consistently good teaching, in an environment that seeks to nurture their love of learning and challenges them to excel.

Jonathan Britton – Headteacher. <http://woldgate.net/>



**Pocklington School** is an Independent day and boarding School for boys and girls aged 3-18. Our aim is to inspire life. We encourage individuals to be confident and considerate; fostering self-respect and self-belief. Personal responsibility and service to others are expected; both have opportunity for expression within the school and beyond.

Mark Ronan – Headteacher. <http://www.pocklingtonschool.com/>



**St Mary and St Joseph**, a Voluntary Aided Roman Catholic Primary School, is in the Diocese of Middlesbrough, serving the Parish of St Mary and St Joseph, Pocklington. Together with our families and members of the Parish, we provide a Christian community where each child is valued for his or her unique talents and personality.

Julie Sutherland – Headteacher. <http://www.stmaryandstjosephrcprimary.co.uk>

**Ex-Officio Governorships:** The vicar is an ex-officio Governor of the two Church of England Schools above (though the posts are currently delegated to church members) and also of Pocklington School.

## PROFILES OF OUR PARISHES

All Saints, Pocklington  
St. Giles, Burnby  
St. Ethelburga, Great Givendale  
St. Martin, Hayton  
St. Mary, Huggate  
All Saints, Londesborough  
St. Margaret, Millington  
St. James, Nunburnholme  
All Saints, Shiptonthorpe

<http://www.pocklingtongroupofchurches.org/>

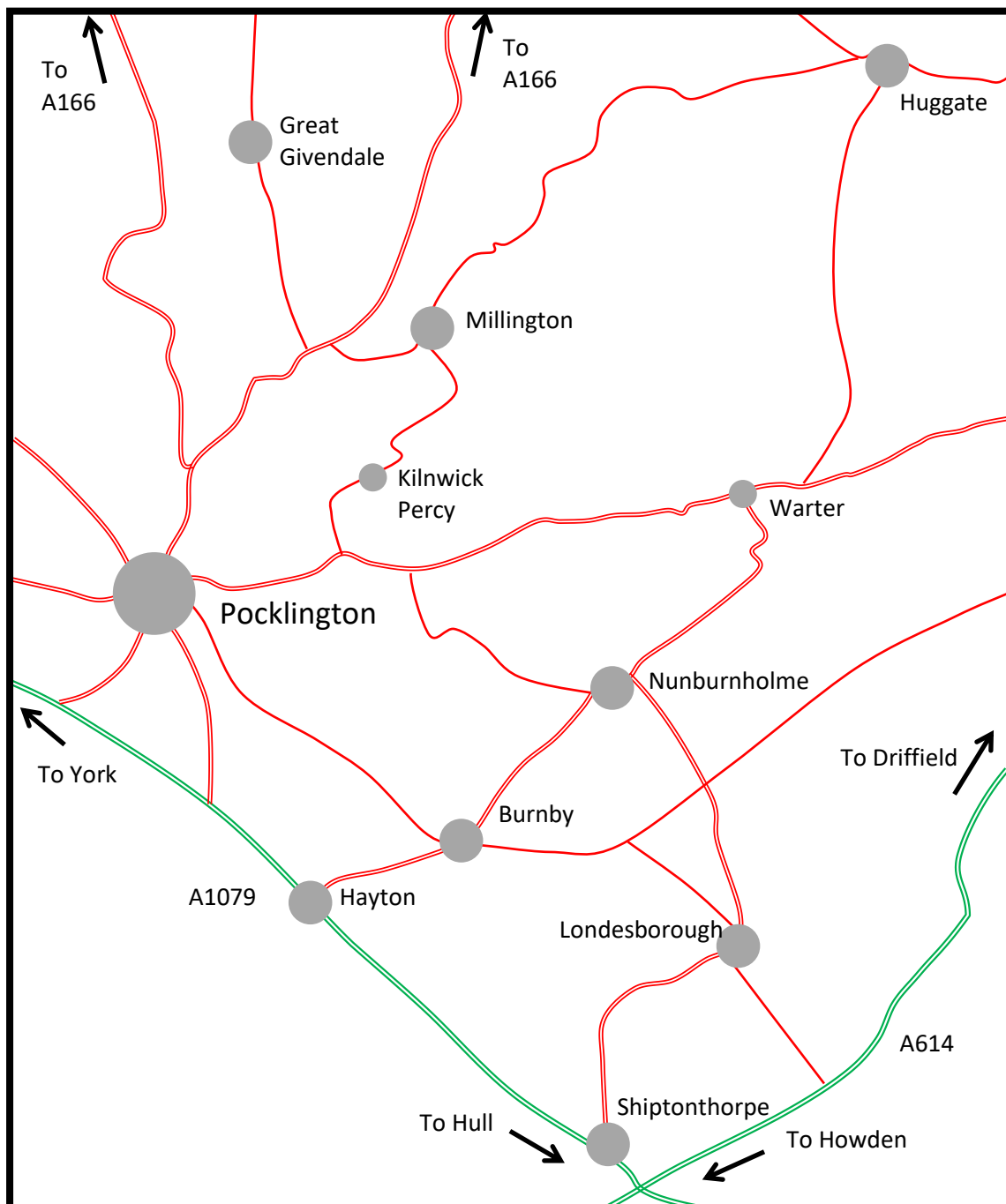



## All Saints, Pocklington

Town  
Population: 8,337  
(2011 Census)

Average Weekly  
Attendance:  
73

Church Electoral  
Roll:  
132 (2017)



Church Capacity:  
300

Annual Income:  
£98,000 (2017)

Freewill Giving:  
£54,000 (2017)

### Worship

We consider ourselves to be a friendly church where we seek to make everyone feel welcome. We meet every Sunday at 10.45am for Common Worship Holy Communion, using an all age alternative on the first Sunday of the month. The Family Communion service aims to be more accessible to families, whilst still having “something for everyone”. Twice a month on a Sunday there is an 8am Holy Communion (BCP) and every Thursday 10am Holy Communion or Morning Prayer (usually BCP). When there is a fifth Sunday in the month we meet together for worship as a group of Churches.



We are very pleased to see numbers rising at our Family Communion, our best attended service, with usually at least ten children. Services at Festival times are always well attended especially at Christmas. At all other services attendance has gradually declined, averaging between 55 and 65. We need to find new ways to renew our worship

and to reach out to families, the 20-40 age group and the people moving into the new housing in town. We would love to see numbers rise and average age decrease!

Once a week there are prayers for Healing and Peace and during the vacancy we have been meeting at various venues across the group to pray for our new vicar and the future of our group of churches.

### Activities and Mission

The Church is open daily, offering a quiet place for prayer and reflection for the local community and the many visitors to Pocklington, many of whom are interested in the history of the building. The building is increasingly used by community and charity groups as well as for Church led activities and events. In addition to our services we also run a broad range of activities:

- **Hospitality** - We offer hospitality, running 2 coffee mornings each week, some to raise money for charities.
- **Children's Club** - Three times a year we run a “Holiday Saints” club for children.

- **School Links** - We have a close relationship with the Church of England Infant School providing three Foundation Governors. There are strong links with Pocklington School, founded in 1514, which still worships each Friday at All Saints during term time. All the schools in Pocklington are welcomed and use the Church regularly for events and services.



- **Mothers Union & "Breakfasts"** - We have an active Mothers Union, as well as Men's and Ladies' Breakfasts. A small fellowship group meets once a month for bible study and prayer.
- **Concerts & Events** - The church building is used as a venue for concerts and performing arts providing a valuable link with wider community groups, civic events and fundraising charity events. Pocklington Singers and Celebration Singers have church connections and regularly hold concerts in the building.
- **Festivals** We hold the annual 'Flying Man Festival' weekend, in and around Church, providing activities, hospitality, and displays from a wide range of community groups. Children love sending their 'Teddies' down the zip wire as part of the weekend. Apart from raising money for All Saints this event attracts a large number of people into our town and building. <http://www.pockflyingman.org.uk/>

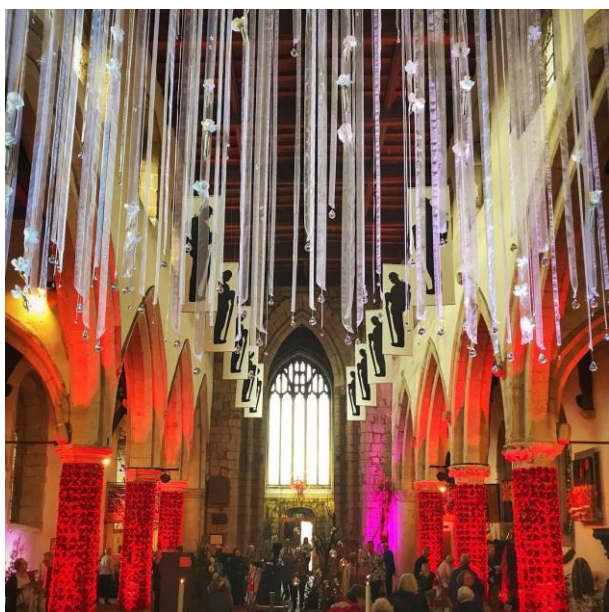

We have recently held a wonderfully successful Flower Festival in September 2018, to mark the centenary of the end of the WW1, with the local flower club, a nationally renowned flower designer and the British Legion. Over the four days we had more than 3000 visitors some of who returned several times to see the moving displays. Fifty flower designers from the north of England came together to tell the story of the war and commemorate the lives of the fifty three local men who lost their lives during and after the war. <http://www.pockflowerfestival.org.uk/>

- **Churches Together** - We occasionally meet together in worship with other denominations in the town through 'Churches Together' and take an active part in the Week of Prayer for Christian Unity.
- **Pocklington Church Friends** - was set up to help with maintaining, protecting and developing the building. The friends hope to increase the general awareness of the heritage of the building and secure its future. <http://www.pocklingtonchurchfriends.org.uk/>



## Church Building

All Saints, known locally as the “Cathedral of the Wolds”, is a beautiful Grade 1 listed medieval building set in the centre of the bustling market town of Pocklington, at the foot of the beautiful Yorkshire Wolds. The present church was built between 1190 and 1460 but there has been Christian worship on the site since the 7<sup>th</sup> century, when St Paulinus first preached in Pocklington and baptised many in the adjacent Pocklington beck. The 120 foot tower houses a peal of 8 bells, some dating back to 1650. They are rung most Sundays by our enthusiastic bell ringing team.



## Revitalisation Project

Much as we love our beautiful, ancient building, we recognise our facilities are limited. We have made some improvements over recent years, but there is further need to make the Church more suitable for modern activities. The PCC is progressing with a strategy to improve lighting, catering facilities, refurbishment and to provide a more flexible church space.

The PCC has created an organisational structure of sub-committees and groups of dedicated volunteers to deal with fabric, finance, fundraising, cleaning, flowers etc. to support and underpin the ministry of the Parish.

## Future Opportunities

The particular challenges for Pocklington are:

- To appeal to our local community as it increases in size
- To find and meet the needs of our local community
- To develop our range of worship and activities
- To find new ways of broadening the age range of people in our church, especially young families
- To make the Church Building more flexible for church and community use



Tour de Yorkshire 2017 passes through the town

## Pocklington Town



Pocklington is a busy historic market town at the foot of the beautiful unspoilt Yorkshire Wolds. There is a weekly Tuesday Market, in addition to a range of small independent shops, cafés, restaurants, bars, health centre, dentists, county library, post office and banks. Our busy, thriving award winning Arts Centre has gained a UK wide reputation for live music, theatre performances and comedy clubs and cinema.

<https://www.pocklingtonartscentre.co.uk/>

As well as five schools, three other Christian churches, it has its own sports centre, and other thriving sports clubs. We also have active young people's uniformed organisations and a small group who are working to reinstate the youth provision in town, involving some church members. There are other active groups such as U3A, Probus, WI and Pocklington flower club. The former WW2 airfield on the edge of the town is home to Pocklington Gliding Club. Nearby Kilnwick Percy Hall Estate is now a Buddhist Centre and is within the Pocklington Parish.



The jewel in the crown of Pocklington is Burnby Hall Gardens and Museum, a short walk from the church and next door to the vicarage. Its 'Lily Pad' café is the venue for Men and Ladies Breakfasts and the tranquil parkland and lake with its large collection of water lilies is popular with all ages, holding events throughout the year and attracting visitors from far and wide.

<https://www.burnbyhallgardens.com/>

Pocklington is considered to be affluent although there are small areas of deprivation and hardship. Around 60% of houses are owner occupied, 30% of housing rented and 10% social rented housing. There are several new housing estates currently being built, so the population is expected to rise in the next few years from 8500 to 10,000.

Pocklington Industrial Estate, just out of town, provides employment for some residents but many commute to York, Beverley, Hull and further afield.



## St Giles Church, Burnby

Village  
Population:  
Approx. 120

Average  
Attendance,  
excluding

Church Electoral  
Roll:  
23 (in 2017)



Church Capacity:  
75

Annual Income:  
£4,017 (2017)

Freewill Giving:  
£3,048 (2017)

### Mission Activities

The church is open daily for the use of villagers and visitors alike for quiet reflection. This is very much appreciated by people, as noted in our visitor's book.

We hold an annual Easter egg hunt in the churchyard, with traditional egg rolling down the church path and a decorated Easter egg competition, which is well attended by villagers. Our Harvest Festival service and supper always proves very popular and our carol singing is appreciated by the community. The church is very grateful for the assistance given by a large number of villagers, some of whom are not church-goers, who contribute money, time or talents, such as flower arranging and organising fundraising and social events throughout the year, mostly held in the church. Monthly coffee mornings are hosted by members of the community in their homes to raise funds for St Giles, whilst also providing pastoral support for the village.

St Giles provides an input to The Link bi-monthly church magazine.



## Worship

Services are held on the 1<sup>st</sup> Sunday of every month, alternating between All Age Worship and Family Communion. In addition, we hold services on major festivals, such as Mothering Sunday, Easter Sunday, Harvest and Christmas Day. We also hold an annual pet service in July and a Carol service. We serve refreshments after every service. We have been very fortunate that one member of the Ministry Team has taken an active interest in Burnby and leads or participates in all our services, plays the organ for us, and makes suggestions for adding special services to recognise major feasts which do not fall on the 1<sup>st</sup> Sunday of the month, such as Pentecost. We know that having one member of the Ministry Team looking after us all the time gives us the continuity that attracts villagers to the Church and our hope is that the new Vicar would allow this to continue.



## Opportunities for the Future



We should like to further improve our visibility in the community and reach out to younger people and families in the parish. We are therefore working on offering a greater variety of services to widen our appeal. As we do not have any other communal space in the village, we see an opportunity for our church to be used more regularly and for a greater variety of community events, as well as church services. With this in mind, we are in the process of

consulting with the Diocese regarding the installation of a portable toilet in the churchyard.

## Challenges for the Future

There has been a service in St Giles Church every Sunday for many years. We have always had large congregations for major festivals (some 50% of the population), but with relatively low attendance for our regular services. This led us to make a significant change in 2017 to one service per month, in addition to major festivals. This has been successful in that the size of the congregation has increased, but it has reduced our income. However, our figures are consistent and in keeping with averages nationwide, considering the size of our village. We are therefore actively reviewing our fundraising activities and methods of generating a higher regular income. Eighteen residents have signed Gift Aid Declarations and the current annual amount of planned giving by way of standing order = £1,482.00 (Gift Aid @25% = £370.50). In Burnby, we recognise that we are a very small part of the large Pocklington Group of Churches and that our needs may not therefore be able to be fully met.

## About Us – St Giles Church

At the heart of the village of Burnby is the small and ancient church, St Giles, which is truly the focal point of the community. The first documented reference to the church, which was built of stone on a simple Norman plan, was in 1282 and endowed with 2 ox gangs of land. Over the centuries, the Church has been altered and restored on many occasions, as shown by the different styles of architecture. The church is in a reasonable state of repair. Routine maintenance keeps the fabric in good condition. The churchyard is well looked after, the grass is mown regularly and we have recently set aside an area for the interment of ashes.



## About Us – The Village of Burnby

Burnby is a rural parish centred on the hamlet of Burnby and extending to outlying farms. It nestles under the Yorkshire Wolds and is just 3 miles from the thriving market town of Pocklington and 15 miles from the beautiful City of York. It is a small community of some 46 houses. There are no schools, shops or public houses in Burnby and the church, which stands on a small mound right in the middle of the village, is the focal point of local life. There is a bus once a week to Pocklington on Market Day. The route 66 cycle route passes through Burnby and many cyclists visit the church.

The population is a mixture of people who work in a variety of occupations and many who are retired. The population is predominantly middle aged, but we have had a recent influx of younger families.

The church figures largely in the social life of the community, with concerts, quizzes and suppers featuring amongst the variety of social events which take place to raise money for the church and to enable the community to get together and have a good time!



Being such a small community, there are no formal organisations based in Burnby, but there is plenty of support for those who are ill, in need or bereaved. Residents play a full and active part in many organisations in the area. They are aware of what is going on in the community, without prying; it is a happy and friendly place to live.



## St. Ethelburga, Great Givendale

Village  
Population: 35

Weekly Church  
Attendance:  
13 (in 2017)

Church Electoral  
Roll:  
18 (in 2017)



Church Capacity:  
60

Annual Income:  
£6,500 (2017)

Freewill Giving:  
£3,240 (2017)

### Mission Activities

The Church is open daily for the use of villagers and visitors alike, for quiet reflection. This is very much appreciated by people, as noted in our "Visitors' Book". The majority of the congregation live outside the parish.

We are on two popular walks (the Minster Way and the Chalkland Way), and our outdoor seats provide a place to reflect and appreciate the wonder of God's Creation, and have a picnic.

### About Us – The Church

St. Ethelburga's Church is on an ancient site, and although rebuilt in 1849, it has retained a Saxon font and a Norman arch. It is famed for its' display of snowdrops and winter aconites. The churchyard is also home to soft comfrey which has a white flower.

Services are held on the 2nd and 4th Sundays of every month, alternating between Evensong and Communion. As we do not have electric light, and all our Services are candle-lit, our Evensong services are replaced by Morning Prayer from September to April.

In addition, we hold our special candle-lit services at Harvest Festival (followed by supper in a barn), and on Christmas Eve (followed by sherry and mince pies in church), both of which are very well attended. We recently started Coffee and a Catch-up, after our Communion Services.

Villagers help to decorate the church with flowers all year round (except Lent and Advent).

The Church is very grateful for the assistance given by villagers, some of whom are not regular church members, but contribute their time and hard work in caring for our beautiful church.

### About Us – The Village

Great Givendale is a rural parish centred on the hamlet of Great Givendale, and includes nearby Grimthorpe and outlying farms. It nestles half-way up the Yorkshire Wolds, giving spectacular views over the Vale of York, and the church overlooks the dry Church Dale in one direction, and Given Dale and its' ancient ponds in the other direction.



It is just under 4 miles from Pocklington, and 17 miles from York. It is a small community of some 16 houses (10 in Great Givendale, and 6 in Grimthorpe). There are no schools, shops, or public houses in Great Givendale, and it is not on a bus route. Most of the properties are owned by the Garrowby Estate, and many residents work locally. It is the home of the Givendale Prime Pedigree Herd of Beef Cattle. Being such a small community there are no formal organisations based in Great Givendale – but it is a happy and friendly place to live.



## St Martin's, Hayton

Village  
Population: 300

Two services pm  
average  
attendance 8+



Church Capacity:  
100

Net Annual  
Income 2017:  
£2,052

### Mission Activities

- The services are held once a fortnight; the first Sunday in the month is Holy Communion and the third Sunday of the month is Morning Prayer.
- We have Holy Communion on Christmas morning at which there is a very warm and happy atmosphere amongst the usually larger than normal congregation.
- We hold services on two of the major festivals-Easter Sunday and Harvest Festival, the latter is followed by refreshments. Unfortunately Remembrance Sunday is always the second Sunday in November and Mothering Sunday has not fallen on our 1st or 3rd Sundays lately.
- We help organise a pre Easter egg hunt jointly with the village hall to raise funds for the same; this brings people in from other areas.
- The interior of the Church is cleaned and brasses kept polished by two volunteers and there is a spring clean once a year by several volunteers. Members of the PCC provide flowers for our services and refreshments when requested.
- We have a small number of signed Gift Aid declarations and try to claim where possible.
- 2017 saw our 4th flower festival, which is organized together with a scarecrow competition. This festival takes place every 5 years in conjunction with the Village hall. It is run over 3 days (Friday-Sunday).
- Our churchyard is well maintained and helped by a Council grant towards grass cutting. We have a small area to attract the wildlife.
- Our PCC secretary plays the organ and the guitar for our singing.

### About us

Hayton is a small village. We have a shop and post office, garage and filling station, a pub with a Chinese restaurant and a Village hall. It is situated on the A1079, with a regular bus service to Hull and York areas. There is no school in the village but primary age Children go to Warter COE, Pocklington Juniors and Pocklington Roman Catholic Junior School. Senior school children attend Woldgate or Pocklington School. The Village hall organises events throughout the year, including an annual village BBQ and Afternoon Delight every first Monday between 2pm and 4pm, where coffee, tea and cake is free for anyone in the village. This community event for people of all ages has between 20 -28 attending. Feedback has been positive and seems to be addressing the potential loneliness of village life. The Pub runs a quiz every other Thursday night. Ladies from the village meet every month for an evening meal at various local restaurants.





The Flower Festival and scarecrow events held with the village hall, see various floral arrangers put their talent into action! The scarecrows are placed throughout the village. On the Friday of the Festival we hold a preview evening in Church for which we sell tickets and serve a light supper with musical entertainment. Each year there is a different theme - last year it was cartoon characters.

### **Church Building and development**

St Martin's Church is a grade 1 listed building. In 2002 we were awarded an English heritage grant which allowed us to repair the tower and external stone work. We were able to repair the third bell which had been stored in the church for 96 years and re-hung it. Bell ringers come from North Cave twice a month at the beginning of the service to ring the bells. We also accommodate any visiting bell ringers on request.

The support from the activities with the village hall for fundraising has helped with church maintenance such as redecorating and maintaining the wooden ceiling beams to prevent woodworm and rot. The maintenance of the wood beams started in 2009 which was the first spray of 3 over a period, of 3 year intervals. We had the stained glass window in the vestry repaired this was removed for restoration and refitted in 2014. This work was funded by money raised at the flower festival.

We would welcome a new Vicar who could give us the support and guidance needed in a relatively small rural Parish such as ours. Our Parish is lacking a visible leader who can reach out to the Community, someone who has the knowledge and experience to help us deal with local issues that may arise from time to time.

**Here are some pictures from our flower festival and scarecrow event**



## St Mary's, Huggate

**Village Population:**  
300  
(2011 Census)

**Weekly Church  
Attendance:** 6  
(in 2017)

**Church Electoral  
Roll:** 28 (in 2018)



**Church Capacity:**  
180

**Annual Income:**  
£11 220

**Freewill Giving:** £4  
500 (2018)

### Mission Activities

- The church is open every day during daylight hours and is frequently used by villagers, visitors, cyclists and walkers as an oasis of calm, away from the frenetic life that many people lead.
- There is a service every Sunday in church offering different types of worship.
- The Pancake Supper is a fun evening before the start of reflections during Lent
- Our annual Summer Fair is popular with Hymns and Pimms in church to start, then a traditional village fair, followed in the evening by a barbeque.
- We maintain the tradition of carol singing every year and are sustained by welcome food and drinks on our rounds.
- The highlight of Christmas is our Christingle service followed by mulled wine and mince pies in church.
- Our large churchyard is maintained by the villagers ensuring that it is a refuge for wildlife and a peaceful, sacred place for people to remember their loved ones.
- As a traditional Wolds village community Harvest plays an important role and the church is always beautifully decorated by the villagers with services and refreshments to celebrate the wonderful area in which we live.
- Outside of the village the church supports the following charities with services and events during the year - Gilead in Uganda, paying the school fees for two young girls whose father teaches at the Deaf Ministry School, Marie Curie, English Church Housing, Salvation Army Hostel Hull and Driffield, Food Bank at Harvest time, Martin House Children's Hospice at Christmas





## Opportunities / Challenges specific to the parish

There is no school in the village; primary aged children attend Warter C of E Primary School which is rated as Outstanding and then Pocklington schools for their secondary education. The village has no community or church hall and no shops, but there is a pub and a bus once a week to Pocklington on Market Day. There is a lot of support from the villagers to maintain the churchyard, flower and cleaning rotas and for the annual Summer Fair. However the attendance at church on a Sunday is decreasing and there is a need to review the timing and type of services on offer. There are currently a significant number of pre-school children in the village and one of the parents enjoys arts and crafts, the introduction of Messy Church could hopefully engage these families.

The church is currently in the process of re-ordering the interior to enable the building to be used as a community facility for activities throughout the week as there is no other venue available. There is a lot of support for this within the village and the Parish Council are supportive. The church is used for the Annual Village Meeting, for polling and by East Riding Tenants Group.

## Church building and surrounding parish

St Mary's Church Huggate is a Grade 1 listed building much loved by the residents and visitors alike. The church is large in comparison to others in the Yorkshire Wolds and the size of the parish. The Churchyard is very well maintained, has extensive views over the Wolds and has recently been extended to allow for further burial plots and an area for the burial of cremated remains.



Huggate is a small village, one of the highest on the Yorkshire Wolds approximately 500ft (150m) above sea level, with 127 houses in the parish including large farming companies JSR Farms and Warter Estate and smaller farmer owned farms. The village is largely hidden



from view apart from the spire of the church which stands out above the trees. Huggate has the second deepest well in England and boasts over 30 km of Public Rights of Way - footpaths and bridleways. Consequently Huggate is popular with walkers and cyclists many of whom visit the church. The village is on long distance routes for walking, The Wolds Way, The Minster Way, The Chalkland Way and the cycling routes The Way of the Roses, The Yorkshire Wolds as well as the Hockney Trail.

## Church Development

In the last ten years £40 000 has been raised by donations, village fundraising activities and through grant applications including YHCT to repair the east window, the roof, stabilising the structural movement of the south porch and reconfiguring the path to and around the church to ensure that church in a good state of repair. The Church has been able to undertake this extensive work largely due to annual significant



donations made by a member of the PCC and fundraising by the villagers. Currently a faculty is being submitted for major repair work required to the floor of the nave, the installation of a toilet and servery, removal of some pews, improving the heating and lighting system, repair of the nave windows, creation of a meeting room and moving the font.

## Service times

1 <sup>st</sup> Sunday:	9.15am	All Age Worship
2 <sup>nd</sup> Sunday:	9.15am	Morning Prayer
3 <sup>rd</sup> Sunday:	9.15am	Holy Communion
4 <sup>th</sup> Sunday:	9.15am	Morning Prayer
5 <sup>th</sup> Sunday:	10.45am	Group Service Pocklington



## All Saints, Londesborough

(Londesborough Wold Benefice)

Village  
Population:  
200

Weekly church  
Attendance:  
8 (in 2017)

Church Electoral  
Roll:  
21 (in 2017)



Church Capacity:  
120

Annual Income:  
£10244 (2017)

Freewill Giving:  
£4500 (2018)

### Mission Activities

As there is no school, pub or shop in Londesborough, the Church is the focal point of the village. We aim to create opportunities for people to gather together, this maybe within the Church Calendar or at Secular events. We welcome all people whether coming to look at Londesborough's history and architecture, join in our social life or seeking quiet contemplation.

### Opportunities for the Future

Our policy is not to leave the church unattended. Opportunities for increasing the open times of the church exist. Developing further contact with Parish Residents to meet in the church in an informal atmosphere needs to be worked upon.

### About Us – The Church



All Saints Church, Londesborough is the second largest church in the group accommodating up to about 120 people. Originally built in the Late C12, evidence of earlier stonework can be seen, and modifications have taken place up to the late C20. Since 2003 the PCC has spent approximately £140k on repairs to the Church Tower, re-roofing the North Aisle, refurbishment of the organ, restoration of our 3 bells, repointing, decorating etc. This has taken place with the help of English Heritage and many other grants, reclaimed VAT and Gift Aid, but principally through specific fundraising.

### About Us- The Village

The Parish of Londesborough is in the south eastern corner of the group, adjacent to Nunburnholme and Shiptonthorpe parishes. It includes nine outlying farms and the village and has a total population of about 200. It has a full mix of age groups. Children attend Market Weighton Infant and Junior schools or Warter School and, in general, move on to the Senior School at Market Weighton. Londesborough has little in the way of

services. A letter box and a bus service on a Tuesday and Friday to Pocklington and Market Weighton markets respectively. It is however blessed with two meeting places which are available to hire.

The Concert Hall is a space of some 105sqm, with additional stage, kitchen and ladies and gents facilities, and the Reading Room, which has two rooms capable of accommodating meetings and parties of up to 10 or 40 people respectively, with a modern kitchen.

Having only one road in, through traffic is limited to agricultural vehicles and cricket club attendees going to Park Farm and the adjacent Cricket Club. The Produce Show has been held annually in the Concert Hall since 1946 and is open to all in the villages of Londesborough, Shiptonthorpe, Goodmanham, Burnby, Nunburnholme and Hayton.

Other than the farms, there are limited employment opportunities within the village, however there is little or no unemployment, folk commuting or being self-employed and having work outside the parish.

In common with many villages, Londesborough is first documented in the Domesday Book and it is probable that the Romans and Vikings also had settlements in the vicinity. Bronze and Iron Age earthworks can also be found. It is recorded by Bede that the conversion of King Edwin to Christianity by St Paulinus took place here. Unlike the other villages in the group, Londesborough remains an Estate Village, with the majority of the houses being tenanted, passing through the hands of the Clifford family, 1469-1643; the Earls of Burlington, 1643-1753 and the Dukes of Devonshire, 1753-1845. George Hudson, the Railway King, bought it in 1845 and sold it again in 1850 to the Dennison family, who, as Earls of Londesborough, entertained royalty here.

### **The Alms Houses, Burlington Row**



The Almshouses were built by the 1<sup>st</sup> Earl of Burlington in about 1678. They now consist of 6 one-bedroomed bungalows and belong to the Londesborough Hospital Charity which is regulated by a scheme of the Charity commission. The four trustees are the Owner of the Londesborough Estate, the Incumbent and two co-opted Trustees.

### **Church Services and the Congregation**

Londesborough has a very strong community spirit with good links to the church. Although the actual attendance at church by people of the village is sometimes low, they always come up trumps at special occasions; Harvest, Christmas Service and other times, fundraising, flower arranging and church sitting. There are three services a month, a morning prayer and Holy Communion from the Book of Common Prayer on the 1<sup>st</sup> & 2<sup>nd</sup> Sunday and common Worship Morning Prayer on the 4<sup>th</sup> Sunday. As with parishes across the country, involving the under 40's in church services is a challenge.





## St Margaret's, Millington

**Village Population:**  
200

**Average church  
attendance:** 10

**Church Electoral  
Roll:** 18



**Church capacity:**  
60

**Annual Income  
C/F 2017/18:**  
£2,300

**Freewill Giving:**  
£4,500

St Margaret's church serves a small village of some 200 people which includes approximately 15 children. It still holds its LEP status though there has not been a Methodist service for some eight years (due to dwindling numbers). The Methodist Minister however takes one service per year (Harvest or Christmas). There are two services a month, one of which is a Communion service. The congregation is small (around ten) but loyal and hard-working. Many of the 'household' jobs are shared amongst the regular worshippers.

The PCC makes an effort to involve the villagers by arranging special services at Harvest and Christmas. The latter aims to involve as much local talent as possible. These services attract many who would not normally come to church. An Annual Art Exhibition, showing the splendid work of the local Art Club, held in church attracts great interest from villagers and visitors alike.



The PCC is looking to increase the footfall in the church via tourists/visitors as the Minster Way passes through the village whilst the Wolds Way passes high on the hill attracting walkers. The Way of the Roses cycle route also passes through the village; this is very popular as the village tea-room is a well-known stop. Also attracting tourists are the Gait Inn, local B & B's and the Village Hall which provides over-night accommodation.

The church is a simple but homely place which holds sixty people. Comments in the visitor's book remark on its tranquillity. The nave dates back to the mid 12<sup>th</sup> century, the chancel being added in the 14<sup>th</sup> century. Of particular note is the stained glass window installed in 2007. It was designed by Tom Denny and shows the Road to Emmaus, the scenery depicts that around Millington. The opportunity to develop church-led community activities such as Coffee mornings is another avenue to be explored to raise the profile of the church.





The Village Hall is a popular place for community activities some of which are: a monthly patchwork group, scrabble evenings, talks, yoga, Pilates, table tennis. It also plays host to Pocklington U3A twice a month. The village parish council organise Yorkshire Day celebrations on alternate years which are well supported by the village community. Over a third of the village residents are aged 60+. Many residents have lived here for 20+ years. These facts present as a settled community which has little wish to change the status quo.

Millington itself, some three miles from Pocklington is reputedly the site of a Roman settlement. It is set at the foot of the Wolds, nestled in a dip surrounded by fields and woods. The one working farm left within the village hints at times past when there were several. It is still very much rural in character with few new buildings erected in the last twenty years.



## St James, Nunburnholme with Warter

**Village Population:**  
150

**Church Attendance:**  
15

**Church Electoral Roll:** 34



**Church capacity:**  
90

**Annual Income:**  
£7482

**Freewill Giving:**  
£2700

### Hopes for the Future

- Increase the attendance of children and young people at services and other events and activities which take place at Nunburnholme St James.
- Continue to support the Christian ethos and development of Warter School.
- Encourage more residents from Warter to attend Nunburnholme St James.
- Further develop St James' role as a focal point for community activity and support for residents of the parish.

### The Parish



The parish consists of two villages, Nunburnholme and Warter, about two miles apart. Nunburnholme lies in a valley on the edge of the Wolds. Its position away from main roads means that there is little through traffic, and the village gives an impression of rural tranquillity. The Wolds Way passes through the village. There is a population of about 150, with an age range from 1 year old to 95 years old; there are several families with children attending Warter

Church of England Primary School, people commuting to work, and retired people. Nunburnholme has a beautiful Grade 1 listed church, a telephone box, and a post box. The church is frequently used for community events.

Nunburnholme was the home of Revd Francis Orpen Morris, a distinguished Victorian naturalist and author of a series of books on British birds. He was Rector of Nunburnholme from 1854 to 1893. He was succeeded in this post by his son, Revd Marmaduke Charles Frederick Morris, who in 1902 donated a new iron bellframe for six bells. He also wrote a number of books about the village and the Yorkshire way of life. Both father and son are interred in the churchyard, near the south porch. Bell ringing groups visit the church regularly. The bells are known locally as the best peal of bells in Yorkshire. Warter is situated on the ridge above Nunburnholme, on the main road between Pocklington and Driffield. It is slightly bigger than Nunburnholme, and is essentially an estate village: most of the housing belongs to the Warter estate, and a majority of the working population works on the estate. Warter has the church school, a post office, and a regular bus service between York and Bridlington (via Pocklington and Driffield); it also has a redundant church, closed in the 1970s, now owned by a Trust, and used regularly by the school.



## Warter C.E. Primary School

There has been a primary school in Warter since the 1850s and it continues to be at the heart of the community. The current school was opened in 1976 to replace the older school and serves the villages of Warter, Nunburnholme and Huggate with approximately 76% of pupils from outside the catchment area. In the past 19 years the school roll has risen from 30 to the current 136 full-time pupils and 22 part-time pupils in Foundation Stage 1. It now has five classes, early admissions room, staffroom, ICT suite, office and kitchen. There is an excellent team of teachers and associate staff who provide a first class education for their children and this was recognised in their last inspection reports where they were graded 'Outstanding' by both OFSTED and SIAMS inspectors.



The school is well respected by the local community and churches and there are many opportunities for everyone to share in some of the major events in the school calendar such as their annual pantomime and end of term, harvest and carol services which are held in the former parish church of Warter.

The school provides a happy, nurturing and secure learning environment, rooted in our strong Christian values. The ethos of care and well-being creates an effective and positive climate where pupils achieve extremely well. Children are happy, confident, articulate and very supportive of their peers. Staff, governors and parents strongly support the positive ethos and the Christian values the school promotes.

## The Congregation and Worship



The normal pattern of worship is: All-Age Worship, led by a member of the Ministry Team, at 10.45 on the first Sunday of the month; and Family Communion at 10.45 on the third Sunday, following Common Worship. Family Communion and All-Age Worship attract a congregation of up to 20, of whom a number come from outside the parish. On occasions the All-Age Worship service is replaced by a special service designed to include pupils from Warter School and their parents. At Christmas the church is usually full for the carol service and

nativity, with up to 90 adults and children attending. The hymn book used is complete Mission Praise (purchased entirely from donations by parishioners and friends).

## Bell Ringing Band

The active bell ringing band was formed in 2011; they ring for Sunday services and practice on Tuesday evenings from 7.30pm until 9pm. It has also become a tradition to ring in the New Year. The bells are checked each month by the Steeple Keepers and the bell ringers organise fundraising events each year for the Bell Fund which is used to purchase new equipment as and when needed.



## The Church

St James' church is a small, quite attractive, Grade 1 listed building. The oldest part is Norman; it was extensively restored in 1872-73, and a major restoration of the tower and bells took place in 2000-01. There is also a Saxon cross which attracts visitors from a wide area. Restoration and maintenance work continues: the PCC is keen to keep the fabric of church in good condition. They have twice applied for a Heritage Lottery Fund Places of Worship Grant, to replace the church roof and undertake other conservation work to the stained glass windows and stonework, but have been unsuccessful.

In addition to worship, the church is often used for many community events such as concerts, heritage exhibitions, history talks, and stained glass workshops.

The Jubilee Committee is a group of volunteers from the village who organise events to fundraise for the church. Its main objectives are to maintain the churchyard throughout the year and provide financial support to the church when needed.

The church has an outside portable WC. A small group of villagers have formed the Community Room Overview Committee (CROC), which has received two grants to research the feasibility of building a Community Room, with kitchen and toilet facilities, next to the church. The diocese fully supports this project.

### **Finance**

The church's income comes mainly from fundraising by the Jubilee Committee, collections at services and planned giving.



## All Saints, Shiptonthorpe

### (Londesborough Wold Benefice)

Village  
Population: 503  
(2011 Census)

Weekly Church  
Attendance:  
15 (in 2017)

Church Electoral  
Roll:  
20 (in 2017)



Church Capacity:  
100

Annual Income:  
£10,929 (2017)

Freewill Giving:  
£5,550 (2018)

### Mission Activities

We aim to draw those in the village into the life of the church. In particular, we seek to make the church a more central hub of the village by keeping it open daily and holding events in the church. In addition to Sunday services weekly throughout the year, since 2006 we have held a short service of Morning Prayer every Friday morning. We aim to make the church building and its people a warm and welcoming place to come when in need or seeking friendship and for private prayer. For the past 3 years, we have collected clothing and other items for refugees in Syria under the auspices of Samara's Aid Appeal – 96 boxes in 2018.

### Opportunities for the Future

We need to create more outreach into the local community, through visits to those in need. We need to increase knowledge of the Church among the younger people and children in the local area, and provide greater facilities for worship.

### About Us – The Church

The largest rural village in the Pocklington Group, Shiptonthorpe church attendance has remained mostly static despite a 20% increase in housing and population since 2000. However, the facilities that people expect, even in rural churches, have been lacking. In 2017 a new external oil-fired heating boiler was installed reducing the noisy and smelly impact of the previous boiler. During 2018, our major restoration, conservation and development project came to fruition, with financial support from the Heritage Lottery Fund, ChurchCare, the Yorkshire Historic Churches Trust and the local community. The roof was renewed, drainage replaced with new rainwater goods and soakaways, and some internal damaged plasterwork will be restored. In addition, a kitchenette and disabled access WC were installed, with a levelled porch entrance and new entrance doors. During the building work, Sunday services were held in the village hall, with Friday Morning Prayer held as a home group in the churchwarden's home. In addition, there is a separate weekly evening home group. The church has a relatively new sound-system, with music provided from CDs or downloaded tracks. Lighting is provided by new energy-saving bulbs. Shiptonthorpe provides an input to The Link bi-monthly church magazine.



## About Us – The Village

There is no school in the village; the primary school was closed in 1979 and converted to a village hall, which has been developed substantially over the past 5 years. The catchment schools are located in the nearby town of Market Weighton, 2 miles away. There are playing fields in the village and a bowling green. The village has a number of other activities: a 2-yearly Open Gardens weekend event with around 25 gardens open, with refreshments in the village hall and a flower festival in the church; NGS gardens are opened each year; the annual pantomime is held in the village hall over a 4-6 day period. There is also an annual Family Barbecue, and the village hall has a monthly licensed evening “Inn at the Hall”. The Village Hall committee organises plays, musical evenings and other events. An Art Group, Keep Fit, Zumba classes and ballet & dance classes are weekly activities in the Village Hall, as well as “Natterbox” coffee mornings. “Folk in the Field” is a new venture, now in its third year, with a daytime fete and produce show, followed by an evening musical event (with groups and solo artists performing). We have a Shiptonthorpe-based Morris Dancing troupe, involving people from our local communities.

The A1079 major York-Hull road (NW to SE) splits the village, but most houses are on the NE side. A new 500 metre spur of the A1079 is scheduled to be constructed in 2020 (with a pelican crossing), to allow the current road to be blocked to form a slip road for the local businesses. There is a regular bus service to Market Weighton and Hull, and to Pocklington and York, as well as to Holme-on-Spalding-Moor, Driffield and Bridlington.

## Church Services

The church holds 4 different Sunday services throughout the month: Holy Communion (BCP), All Age Worship, Morning Prayer (BCP) and Family Communion (CW), all at 10.45am. The Friday Morning Prayer is a short 25 minute said service at 9.30am. Sunday services are led by a member of the Group Ministry team. Within the Group Ministry Team, the village has a parish ministry team comprising a retired Priest (who also ministers across the Pocklington Group and is a trustee of the Shiptonthorpe Charities), a licensed Reader (with responsibility for Youth Work across the Group) and a Pastoral Assistant, (who is the Foundation Governor of Warter School in the Pocklington Benefice, and leads Worship time and an after-school worship club).



## Major local businesses

Langlands Garden Centre with Restaurant, Drakes Car Dealership & Repairs, BP Petrol Station, Spar mini-market, McDonald's Restaurant, George F White (commercial estate agency). Many other smaller local businesses operate within or from the village.

## Facilities

Village Hall, Playing Fields, Bowling Green, Children's play-park.

## Changes since 2000

Closure of both Public Houses and the Methodist Chapel. Closure of 2 Garages (Petrol Stations). Large Indian Restaurant converted to Fish & Chips Restaurant (currently closed, but with new signage for a restaurant & bar with car-wash facilities). Opening of Spar mini-market, McDonald's Restaurant, George F White Estate Agency (in previous Crown Public House) and B&B accommodation (in previous Ship Inn Public House)



## Our Resources

### Ministry and Pastoral team

We have a large ministry team who work across the group, leading worship and taking a pastoral oversight of some of the parishes.

The team comprises:

- 5 retired clergy, all with permission to officiate,
- 5 readers, one soon to be ordained Deacon, and 2 in training
- 5 recognised parish assistants helping with worship and pastoral visiting.
- 6 parish visitors working across the group of churches
- There is provision for a house for duty priest. At present this post is not filled.



### Administration

We have two people who work part time in the church office based at Pocklington providing 18 hours of administration help for staff, ministry team and churches in the group.

### Baptism team

We have a team of people who prepare families for baptism.

### Young people

We run Holiday Saints at Christmas, Easter and in the summer. “Open the Book” goes into schools in our area. There is currently however no youth work within our group of churches

### Safeguarding

There is a Safeguarding Representative for the whole Group supported by a Safeguarding Officer in each Parish.

### Church Wardens

There are 1 or 2 Church Wardens in each of our Churches.

### Worship

There are services in at least 6 of the churches each Sunday, a minimum of which 2 are Holy Communion. If there is a fifth Sunday we have one group service which is always Holy Communion with Morning Prayer in one of the villages.

Please see below a sample rota of services in the group

## Sample rota of services in Pocklington Group of Churches

**2018**

Date Calendar	<b>1-Jul Trinity 5</b>	Service		President/ Officiant	Preacher	Assistant	Notes
8.00am	Pocklington	HC	BCP	VH	VH		
9.15am	Burnby	FS	CW	BB	RN		Pet service
	Hayton	HC	CW	PMB	PMB		
	Huggate	AAW		AH			
10.45am	Londesborough	MP	BCP	BS	BS		
	Nunburnholme	AAW		RN	RN	BM	
	Pocklington	FC	CW	LJS	BB	BB	
	Shiptonthorpe	HC	BCP	VH	VH		In Village Hall

Date Calendar	<b>8-Jul Trinity 6</b>	Service		President/ Officiant	Preacher	Assistant	Notes
9.15am	Huggate	MP	CW	AH			
	Millington	HC	CW	SJ	SJ	JH	
10.45am	Londesborough	HC	CW	PMB	PMB		
	Pocklington	SE	CW	AJB	AJB	JH	
	Shiptonthorpe	AAW		SJ	SJ	FB	In Village Hall
6.00pm	Gt Givendale	EP	BCP	BS	BS		

Date Calendar	<b>14-Jul Saturday</b>	Service		President/ Officiant	Preacher	Assistant	Notes
2.00pm	Huggate	Special		BB			Hymns & Pimms

Date Calendar	<b>15-Jul Trinity 7</b>	Service		President/ Officiant	Preacher	Assistant	Notes
8.00am	Pocklington	HC	BCP	AJB	AJB		
9.15am	Hayton	MP	CW	DVR	DVR		
	Huggate	HC	CW	No service			Moved to 14 July
10.45am	Nunburnholme	FC	CW	LJS	DVR	DVR	
	Pocklington	SE	CW	PMB	PMB	PD	
	Shiptonthorpe	MP	BCP	MB	MB		In Village Hall

Date Calendar	<b>22-Jul Trinity 8</b>	Service		President/ Officiant	Preacher	Assistant	Notes
9.15am	Gt Givendale	HC	BCP	RN	RN		Take THE BOX
	Huggate	MP	CW	BB	BB		
	Millington	MP	CW	PD	PD	JH	
10.45am	Londesborough	MP	CW	BB	BB		
	Pocklington	SE	CW	RN	BM	BM	RN   Baptism follows
	Shiptonthorpe	FC	CW	LJS	MB	MB	In Village Hall

Date Calendar	<b>29-Jul Trinity 8</b>	Service		President/ Officiant	Preacher	Assistant	Notes
9.00am	Shiptonthorpe	MP	BCP	MB			In Village Hall
10.45am	Pocklington	HC	CW	Bishop John		DVR	Group service



## The Vicarage

The vicarage was built in 1960 and offers good sized family accommodation. It is located near to Burnby Hall Gardens and a 5 minute walk from All Saints Church in Pocklington where the Group Office is situated. There is a large garden providing privacy with space to entertain. There is ample off road parking with a garage and outbuilding providing a significant amount of storage.



On the ground floor there is an entrance hallway, a study, WC, living room with gas fire and French doors overlooking the garden. A folding partition wall opens to the adjacent dining room. The entrance hallway leads to a large fitted kitchen with patio doors overlooking the garden. In the kitchen there is an electric cooker, space for a fridge, freezer, washer, dryer and space for a small dining table. There is a separate walk in larder.

On the first floor there are four double bedrooms with cupboards/wardrobes. Family bathroom, separate WC with sink and an additional separate shower with WC and sink.

The house is in a good state of repair, with gas central heating and double glazed throughout.

The [Vicarage floor plans](#) on the next page are the architectural drawings from 2001 when the building was extended to give a larger kitchen and fourth bedroom.



View towards the Vicarage from the top of the Tower!

# Vicarage Floor Plans

## Ground Floor

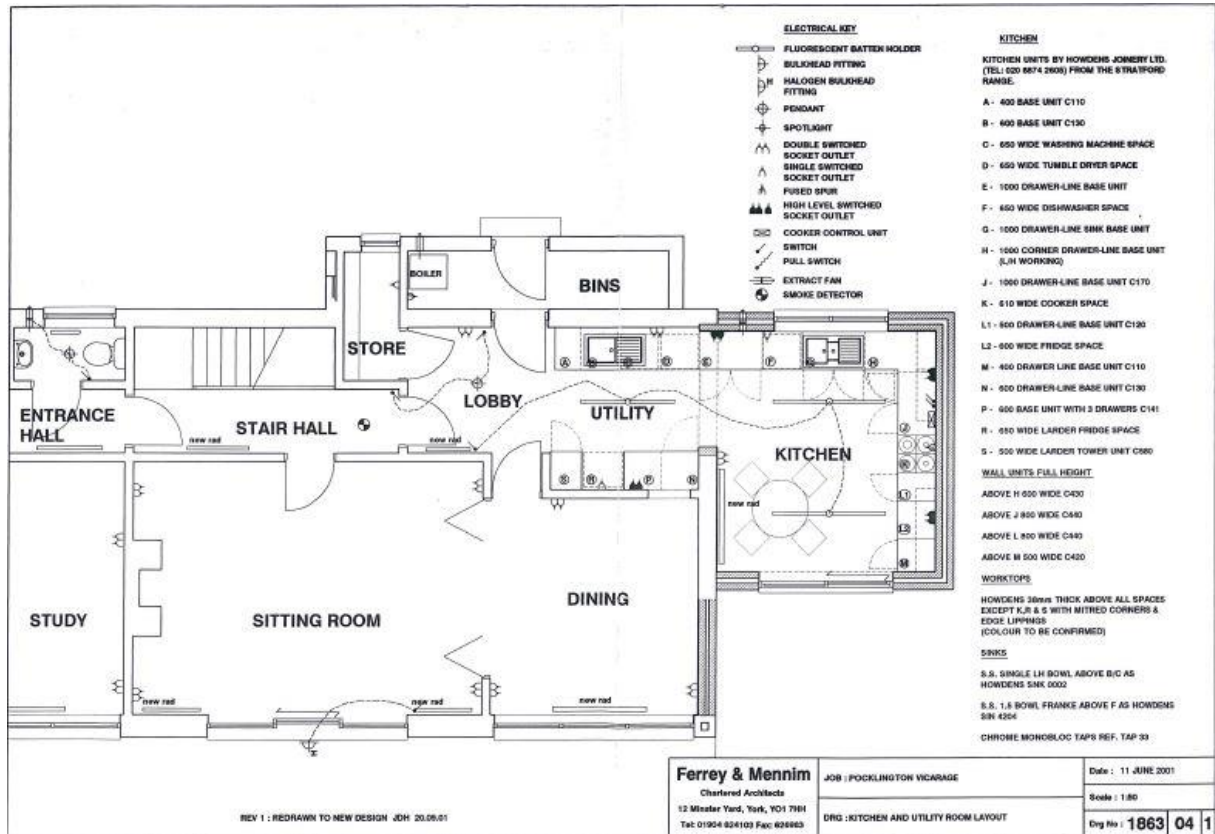

## First Floor

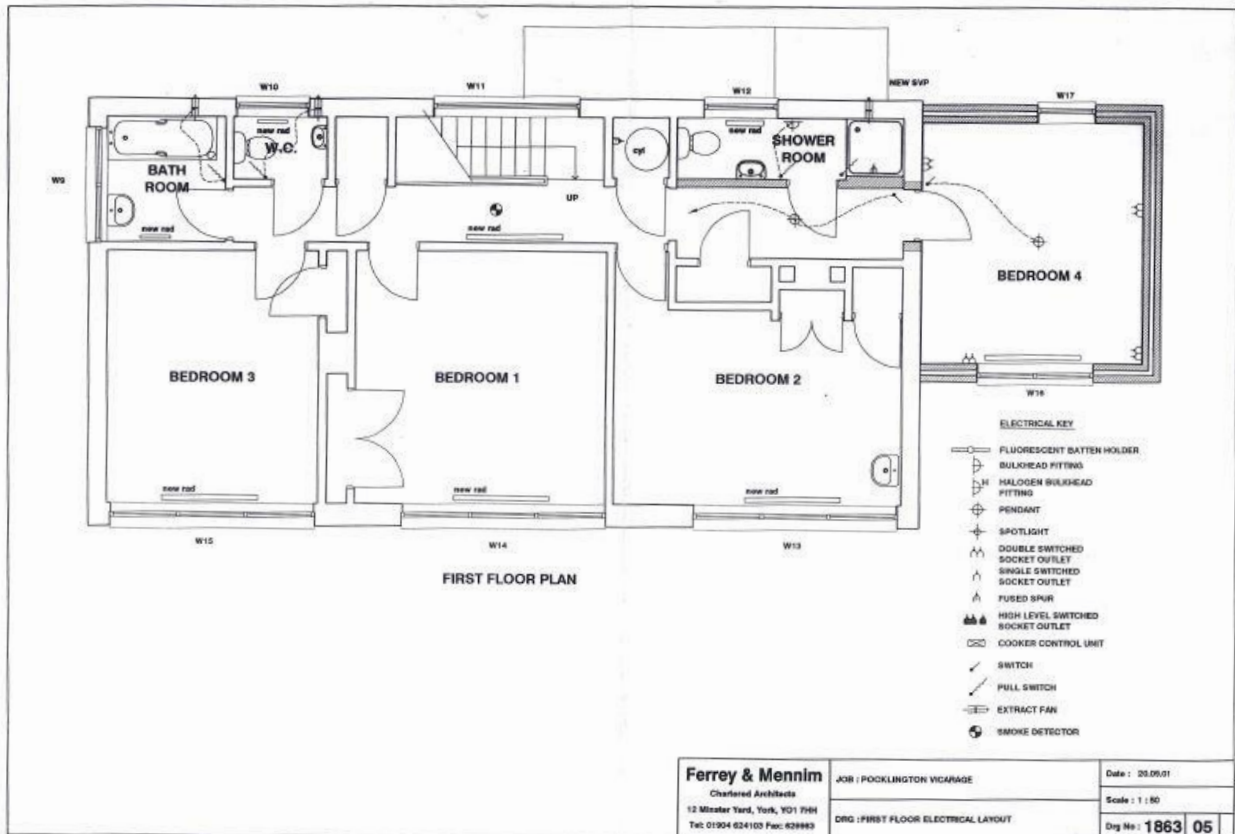



## Our Local Area

Pocklington and the surrounding area is a great place to live! It is on the edge of the beautiful Yorkshire Wolds and all the villages in our group are within a few miles in an area to the East of the town. The area is great for walking and cycling and is a largely undiscovered part of the country. The Way of the Roses cycle route goes through Pocklington and two of our villages. The area has seen the Tour de Yorkshire pass through for two years bringing many people to the area. The Wolds Way, Minster Way and Chalkland Way walking routes passes through the beautiful local countryside.



Many of the local villages have a local pub, eating establishments and Shiptonthorpe boasts a large and successfully family owned Garden Centre and Nursery renowned across Yorkshire.

There is also the lovely nearby Pocklington canal, designated as a site of special scientific interest with its walking route and wildlife.



Apart from good local amenities we are within easy car drive or bus journey to York, Hull and Beverley. The lovely east Yorkshire coast is reached within an hour by car.

